

MAINTENANCE PROJECT #90004C

- FROM STA. 65+92 TO STA. 80+00 EXIST. CABLE
- ABANDONED IN PLACE
- HH#03725 PLACED AT STA. 65+72
- REEL #733234 SPLICED IN
- NEW PVC & CABLE PLACED
- CABLE PULLED THRU EXIST. GULF HH & BRIDGE ATTACH.

**AS BUILT**

FEB 24 1986 U.C.I.

CABLE	6146'		REVISED
C/R - A	392'	8	8-5-85 ADD R/W DATA
B/J 4" BIP			9-12-93 #90004C MAINTENANCE PROJ.
B/J 8" BIP			
4" SPVC	425'	10	
HAND TRENCH	100'	10	
C/R - G			
C/R - CURB	1	1	
C/R SHELL	416'	1	
4" PVC	608'		
ITEM	QUANTITY	UNIT	

**SOUTHLAND FIBERNET**

FIBER OPTIC CABLE ROUTE

MOBILE-PENSACOLA

PREPARED BY

UTILITY CONSULTANTS, INC.

DATE: 6-7-85

ENGINEERED BY:

DRAWN BY:

CHECKED BY:

APPROVED BY:

SCALE: H-1"=100' V-1"=20'

SHEET 2 OF 7

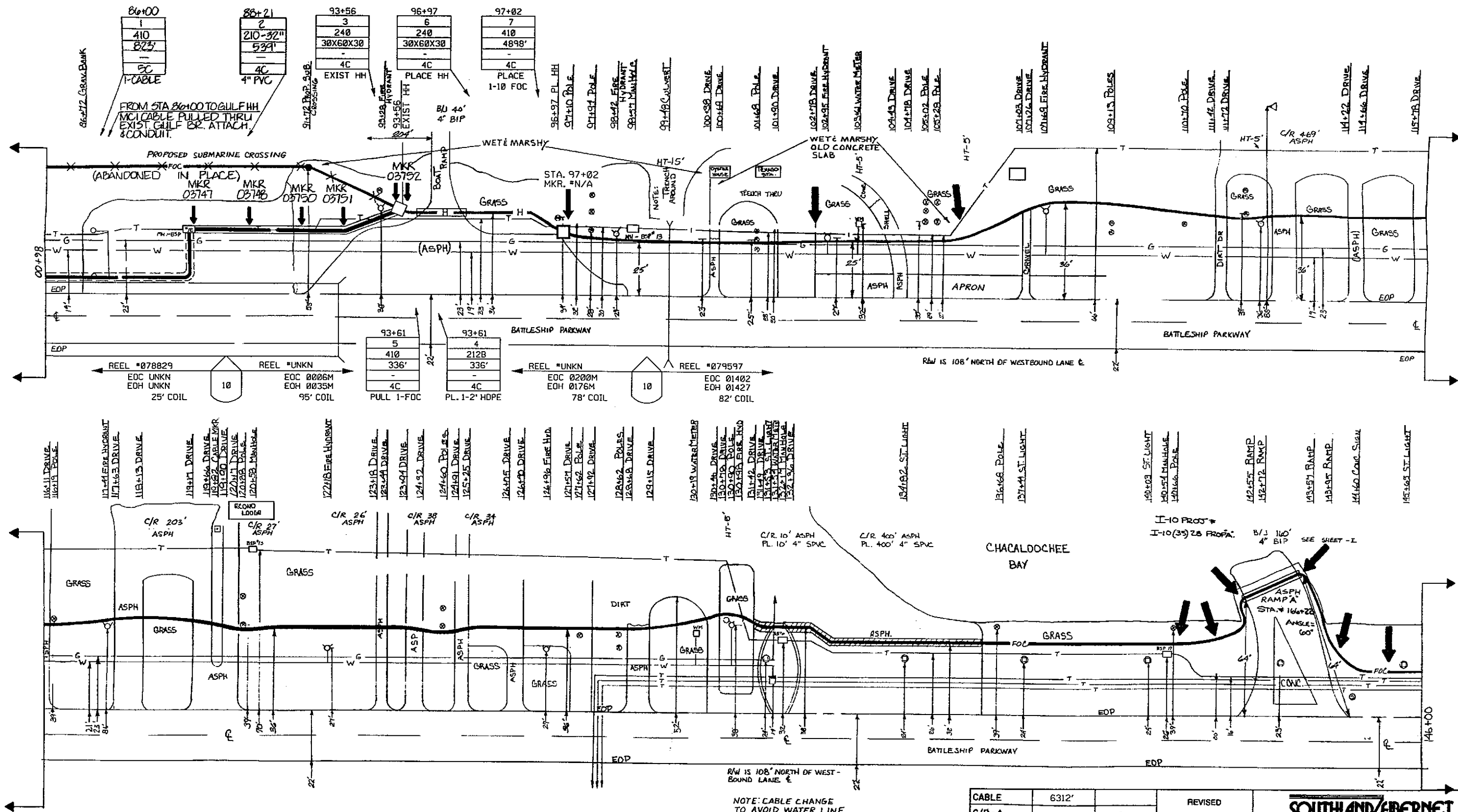

MAINT. #90406C, MOBILE, AL. FROM STA. 93+61  
 SPLICED 10 FOC & PLACED 336' OF 1-2" HDPE ALONG  
 EXISTING R/L. PLACED SPLICE & NEW HH AT STA.  
 96+97. WORK WAS REQUIRED TO REPAIR CUT FOC.

MAINTENANCE PROJECT #90004C  
 • FROM STA. 86+00 TO STA. 93+56 EXIST.  
 • CABLE ABANDONED IN PLACE.  
 • REEL #733234 SPLICED IN  
 • CABLE PULLED THRU EXIST. GULF BRIDGE  
 ATTACH. & HH.  
 • NEW PVC & CABLE PLACED.

**AS BUILT**  
 FEB 22 1986 U.C.I.

CABLE	6312'		REVISED
C/R-A	1207'	8	8-9-85 ADD 240 D801P
B/J 4" BIP	40'	1	5-12-85 #1000916
B/J 8" BIP	150'	1	MAINTENANCE PROJ.
4" SPVC	1220'	8	9/82 #90406C IDC
HAND-TRENCH	35'	5	MAINTENANCE PROJ.
C/R-G			
C/R-C			
2" HDPE	336'		
SUBM X'ING	572'		
ITEM	QUANTITY	UNIT	

**SOUTHLAND FIBERNET**

**FIBER OPTIC CABLE ROUTE**

MOBILE - PENSACOLA

PREPARED BY  
UTILITY CONSULTANTS, INC.

DATE: 6-7-85	CHECKED BY:
ENGINEERED BY:	APPROVED BY:
DRAWN BY:	
SCALE:	SHEET 3 OF 57

TUSF1003.DGN  
 TUSF1003.CIT



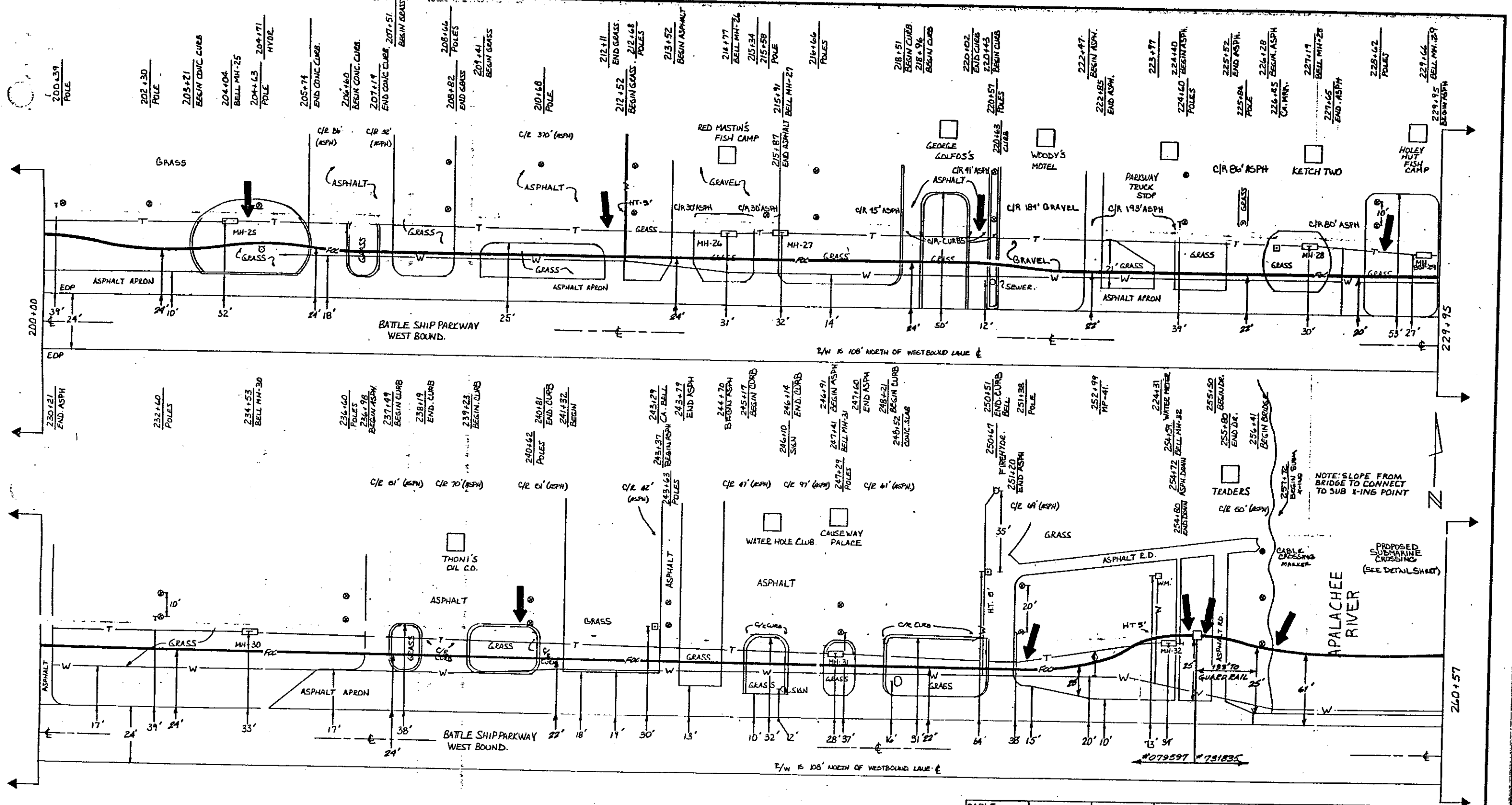

**AS BUILT**

11/28/85 DDD L.C.Z.

CABLE			REVISED		SOUTHLAND FIBERNET	
ITEM	QUANTITY	UNIT			FIBER OPTIC CABLE ROUTE	
					MOBILE - PENSACOLA	
C/R-A	6057'				PREPARED BY	
B/J 4" BIP	150'	13				
B/J 8" BIP					UTILITY CONSULTANTS, INC.	
4" SPVC						
HANDTRENCH	15'	3			DATE: 6-7-85	
C/R-B	184'	1				
C/R-C					ENGINEERED BY: UCI	
C/R-CURBS		15				
SUBM. XING	285'				DRAWN BY:	
					SCALE:	
					CHECKED BY:	
					APPROVED BY:	
					SHEET 5 OF 57	

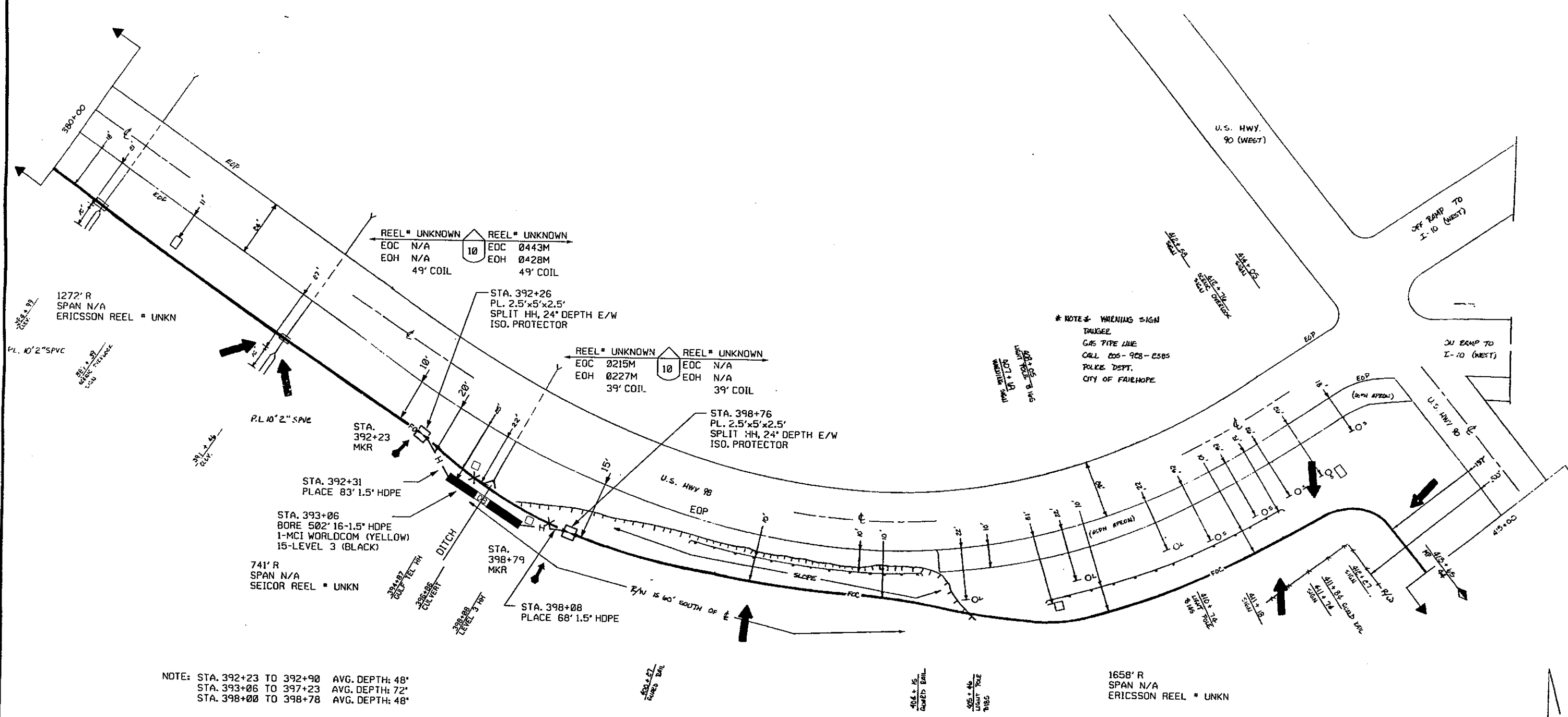

NOTE: STA. 392+23 TO 392+90 AVG. DEPTH: 48"  
 STA. 393+06 TO 397+23 AVG. DEPTH: 72"  
 STA. 398+00 TO 398+78 AVG. DEPTH: 48"

PROJECT \*90406H; DAPHNE, AL. FIBERNET CABLE RESTORATION.  
 PLACED CONDUIT/CABLE, MARKERS AND HANDHOLES/SPLICES  
 FROM STA. 398+79 TO STA. 392+23 DUE TO CABLE CUT.

**AS BUILT**  
 FEB 26 1996 *LLC.I*

REVISIONS			
DATE	DESCRIPTION	INITIAL	
8/85	R/W DATA		
5/00	MAINT.*90406H	LJD	

MATERIAL LIST	
CLARIFICATION NO.	QUANTITY
CABLE	3671'
1.5" HDPE	1155'
2" SPL PVC	10'
2.5"x5'x2.5' HH	2
ISO. PROTECTOR	2
BUR. CBL. MKR.	8

**SOUTHLAND FIBERNET**  
 FIBER OPTIC CABLE ROUTE  
 MOBILE - PENSACOLA  
 PREPARED BY  
 UTILITY CONSULTANTS, INC.

DATE:	
ENGINEERED BY:	TUSFL008.01A
DRAWN BY:	TUSFL008.CIT
SCALE:	SHEET 8 OF 57

415+58 D.E. BOX  
415+60 WEST SIDE  
416+10 CURED BAIL

418+47  
418+47 WEST SIDE  
418+47 WEST SIDE  
418+47 WEST SIDE  
418+47 WEST SIDE

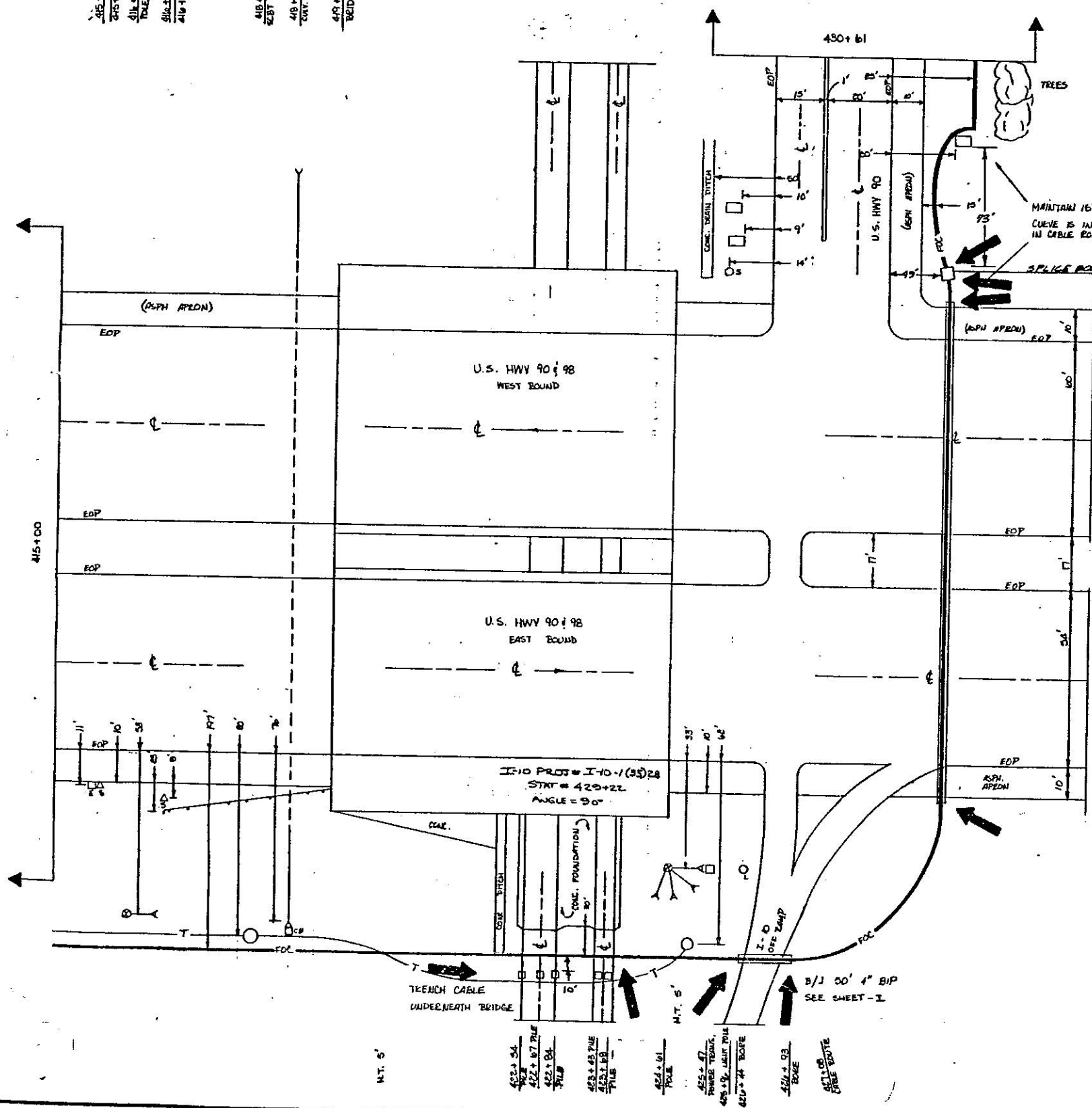

430+47  
CABLE ROUTE

429+76  
CABLE ROUTE  
429+76  
NORTH SIDE EOP

429+17  
EOP

429+89  
EOP

B/J 170' 4\"/>

429+28  
NORTH SIDE  
429+15  
CABLE ROUTE

**AS BUILT**

FEB 26 1985 M.C.I.

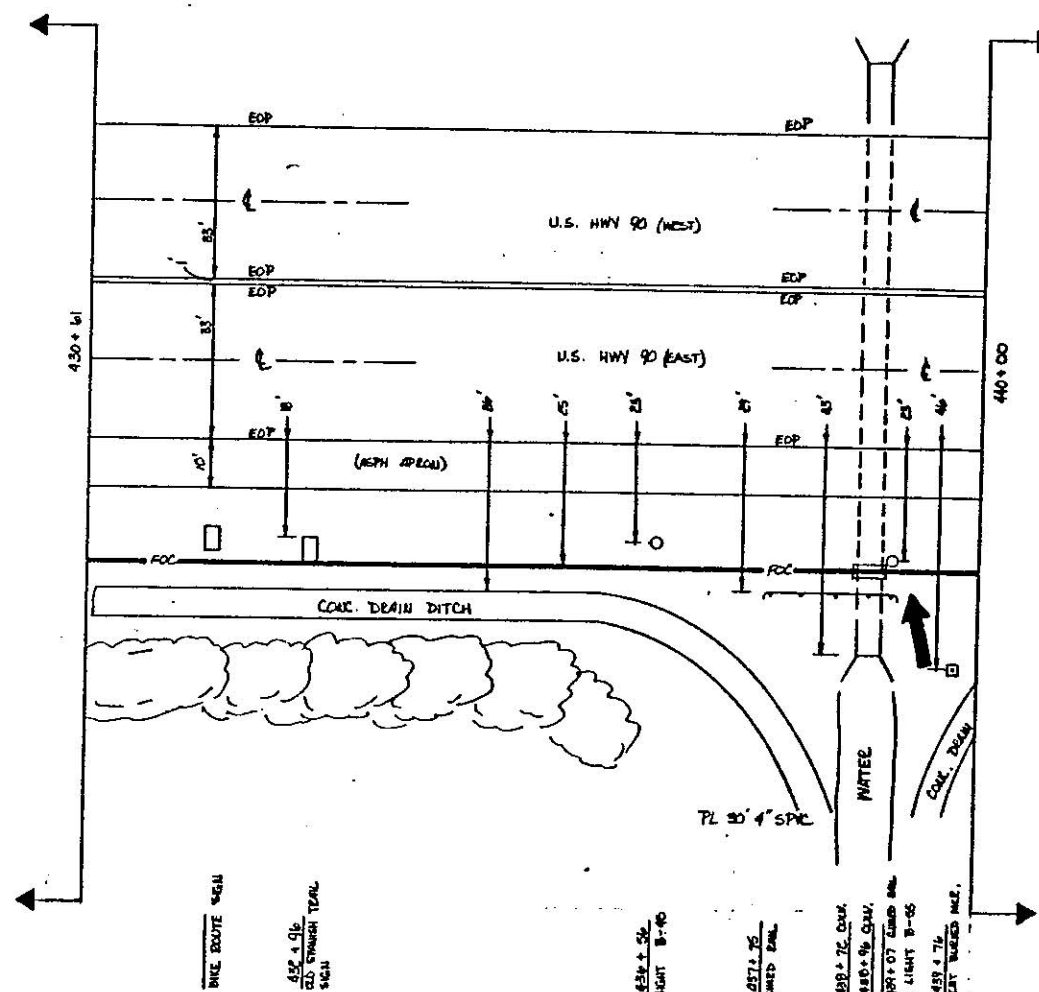

CABLE	2300'		REVISED  CABLE LOCATION CHANGED B-9-B5	SOUTHLAND/FIBERNET	
C/R-A				FIBER OPTIC CABLE ROUTE	
B/J 4" BIP	205'	2		MOBILE - PELISACOLA	
B/J 8" BIP				PREPARED BY	
4" SPVC	30'	1		UTILITY CONSULTANTS, INC.	
HAND-TRENCH	10'	2		DATE: 6-7-85	
C/R-G				ENGINEERED BY: UCI	
C/R-C				CHECKED BY:	
C/R				DRAWN BY:	
				APPROVED BY:	
ITEM	QUANTITY	UNIT	SCALE:	SHEET 9 OF 57	